

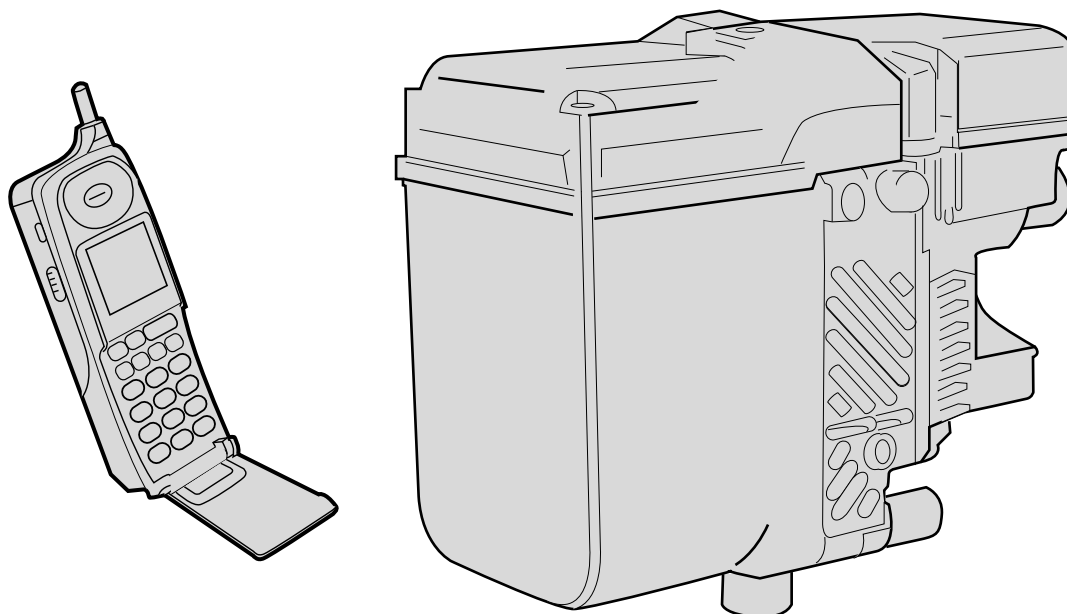

Parts and Accessories Installation Instructions



053 0307 Z

Thermo Call 1.1 retrofit kit

BMW 5 Series (E 39) and 7 Series (E 38) with auxiliary heating system identical to series

The installation time is approx. 1,5 - 2 hours, but this may vary depending on the condition of the car and the equipment in it (the installation time will be reduced to 1 hour if the Thermo Call is installed at the same time as the retrofit auxiliary heating system).

Retrofit kit No. 64 50 0 149 365
 64 50 0 151 210
 64 50 0 151 211



In the Federal Republic of Germany the Vodafone contract and the registration form must be completed immediately after the car is accepted and then sent to the specified fax number.

In other countries a prepaid card must be purchased on which the PIN query can be disabled.

The phone number for Thermo Call is available from the relevant network operator. ◀

Contents

Section	Page
Important information.....	3
1. Preparations.....	4
2. Parts list	5
3. Thermo Call wiring harness connection diagram	6
4. Thermo Call additional cable connection diagram	7
5. To install the Thermo Call aerial	8
6. To install the Thermo Call control module	9
7. To connect Thermo Call	10
8. To install the LED	13
9. Concluding work and programming	14
10. Thermo Call circuit diagram	15
11. How to use and test Thermo Call	17

Important information

The retrofit kit is for use within the BMW dealership organisation only.

Do not kink or damage the cables during the installation work since otherwise they may cause faults that can later only be identified by extensive additional work. The costs incurred as a result of this will not be reimbursed by BMW.

If the specified PIN chambers are occupied, bridges, double crimps or twin-lead terminals must be used.

This Thermo Call retrofit kit does not require coding.

The electrical connection of Thermo Call is made in parallel to the connection **X18830** of the receiver for the auxiliary heating system. On E38 cars this is behind the rear seat bench on the left. On E39 cars the connector X18830 is on the right behind the rear seat bench (Saloon) or in front of the spare wheel trough (touring).

The LED supplied in the retrofit kit may only be fitted if the auxiliary heating system is not controlled using MID, BC, BM or using multifunctional clock or remote control.

Target group

The target group for these installation instructions is specialist personnel trained on BMW cars with specialist knowledge of vehicle electrical systems.

Work:

All servicing, repair and installation work on BMW cars is completed at your own risk.

All work must be completed using the latest BMW repair manuals and circuit diagrams in a rational order using the prescribed tools (special tools) and observing current health and safety regulations.



The SIM card must be inserted before you install the Thermo Call control module.

Do not insert or remove the SIM card when the Thermo Call control module is connected to the voltage supply. This will cause damage to the module or to the SIM card. ◀

Thermo Call licence

European Union and conformity states

Directive 95/54/CE

Regulation No. 10 ECE-ONU/2

e3*72/245*95/54*7001*00

E3 10R-02 7001-00

Special tools required

DISPlus, MoDiC III or GT-1

1. Preparations

	TIS instruction No.
Conduct a brief test	---
Disconnect the negative pole of the battery	12 00...

The following components must be removed first of all:	---
Glove compartment	51 16 360
Base module	51 10 210
A pillar trim on the right	51 43 201
A pillar footwell trim at the bottom right	51 43 075
Front right door sill strip	51 47 000
Bottom B pillar trim on the right	51 43 150
Rear seat bench	52 24 005
Rear right door sill strip	51 47 030
Rear seat backrest	52 24 015
Also remove the following components if you wish to install the LED:	
Gearshift/Selector lever cover	51 10 210
Hazard lights and central locking button	61 31 079

2. Parts list

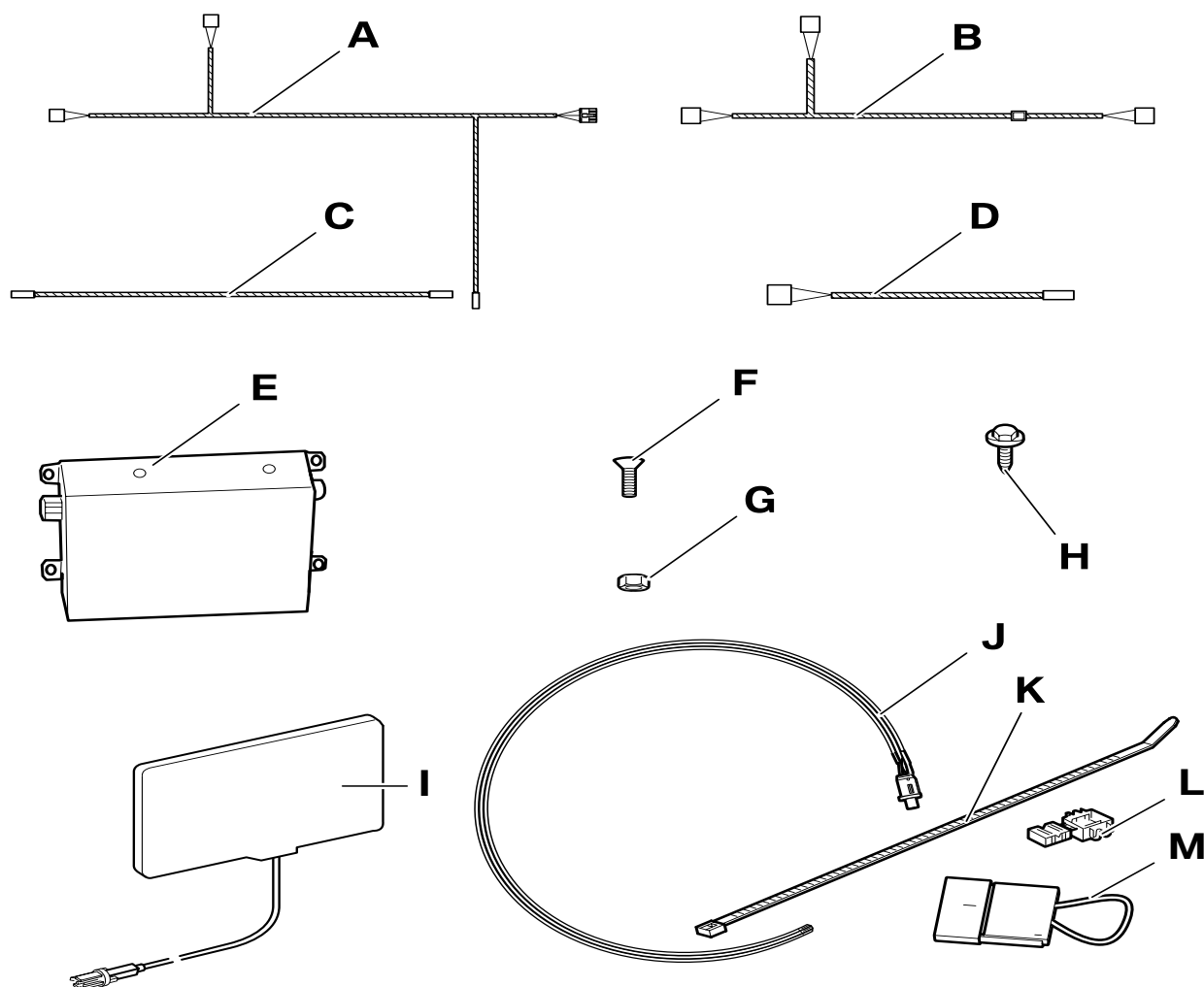

053 0337 Z

Legend

- A Thermo Call wiring harness
- B Thermo Call wiring harness extension
- C LED extension (only required if you wish to fit the LED)
- D Adapter cable (for remote control receiver T60 only)
- E Thermo Call control module
- F Countersunk screw M4 x 25 mm (4x)
- G Hexagonal nut M4 (4x)
- H Fillister head self-tapping screws St 2.9 x 25 (4x)
- I Adhesive aerial
- J LED
- K Cable tie (20x)
- L Connector (4x)
- M Cable bridge

3. Thermo Call wiring harness connection diagram

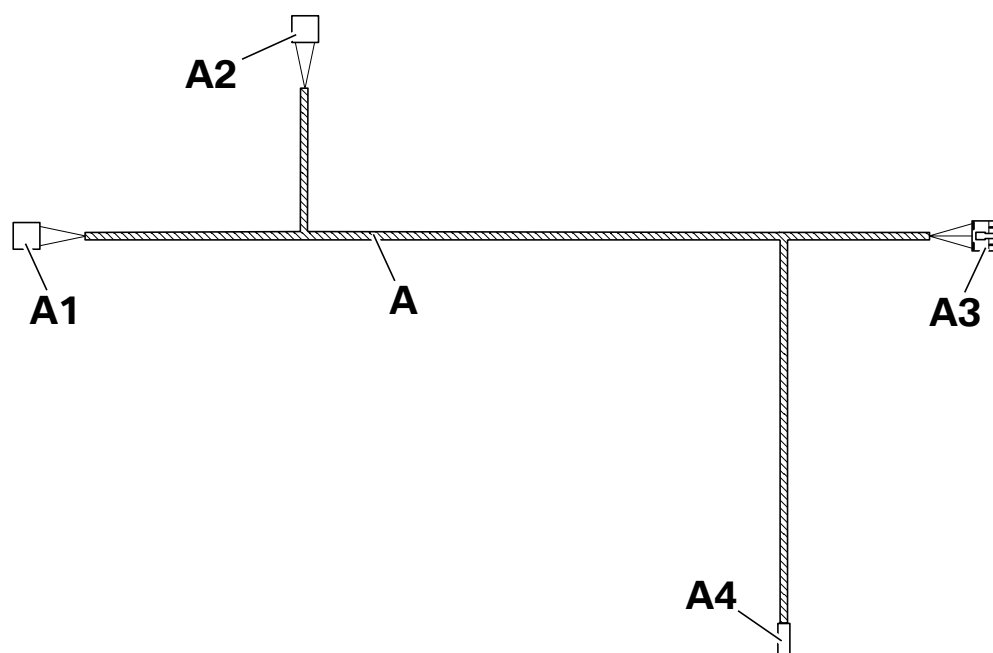

053 0344 Z

Item	Description	Signal	Cable colour / Cross-section	Connection location in the car	Abbreviation / Slot
A	Thermo Call wiring harness	---	---	---	---
A1	6-pin black plug	---	---	Connect to connector B2 on the extension B	X3887
A2	6-pin black plug	---	---	Connect to connector B1 on the extension B	X3887
A3	12-pin black plug	---	---	To Thermo Call control module	X18130
A4	4-pin plug, white	---	---	To the LED J	X4763

4. Thermo Call additional cable connection diagram

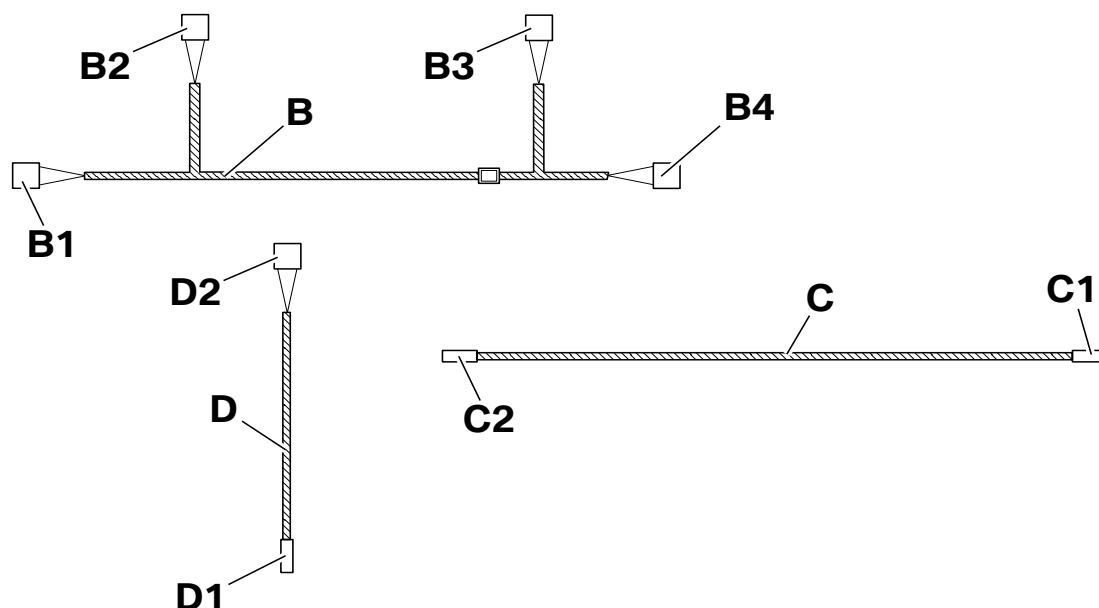

053 0345 Z

Item	Description	Signal	Cable colour / Cross-section	Connection location in the car	Abbreviation / Slot
B	Thermo Call wiring harness extension	---	---	Between Thermo Call wiring harness and the connection cable for the remote control receiver	---
B1	6-pin black plug	---	---	To connection A2 on the Thermo Call wiring harness A	B1 marked with banderole, X10167
B2	6-pin black plug	---	---	To connection A1 on the Thermo Call wiring harness A	B2 marked with banderole, X28S
B3	6-pin black plug	---	---	To plug X18830 on the remote control receiver for the auxiliary heating system *	B3 marked with banderole, X28S
B4	6-pin black plug	---	---	On the remote control receiver for the auxiliary heating system	B4 marked with banderole, X18721

*If no remote control is fitted, connect the bridge **M** to the branch **B3**.



The extension **C** is not required. ◀

Item	Description	Signal	Cable colour / Cross-section	Connection location in the car	Abbreviation / Slot
D	Adapter cable	---	---	Between Thermo Call wiring harness and receiver T60	---
D1	6-pin black plug	---	---	To connection A1 on the Thermo Call wiring harness	X11335
D2	6-pin plug, white	---	---	To the remote control receiver T60	X11336



The adapter cable **D** is only required for cars with a T60 receiver. ◀

5. To install the Thermo Call aerial

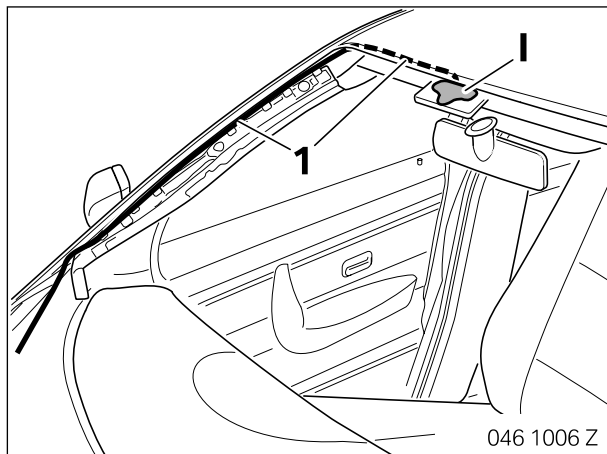

Install the aerial cable (1) in such a way that the deployment of the head airbag is not impeded. ◀

Clean the windscreen in the area where the aerial is to be affixed.

The gluing temperature must be at least 20°C.

Affix the aerial I on the right next to the rear-view mirror.

Lay the aerial cable (1) along the standard wiring harness to the installation site of the Thermo Call control module.

6. To install the Thermo Call control module

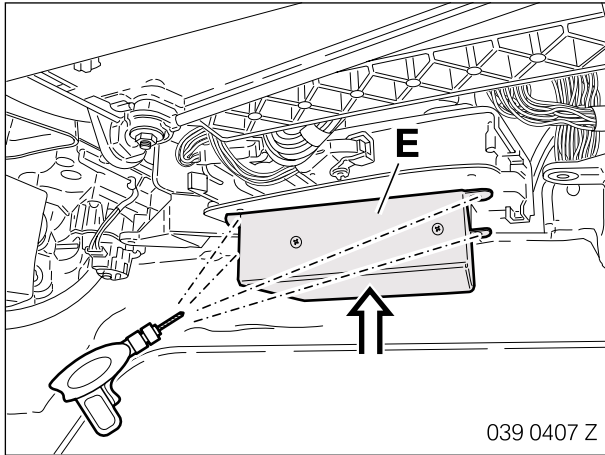

Place the Thermo Call control module **E** against the module holder and mark the holes.

Drill the holes with a 6 mm drill bit.

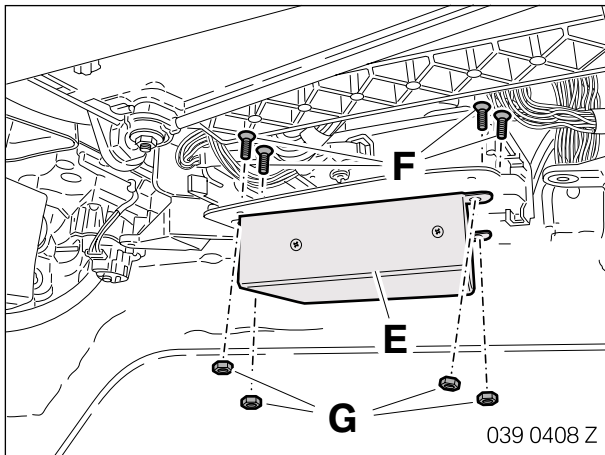

Secure the Thermo Call control module **E** with countersunk screws **F** and hexagonal nuts **G**.

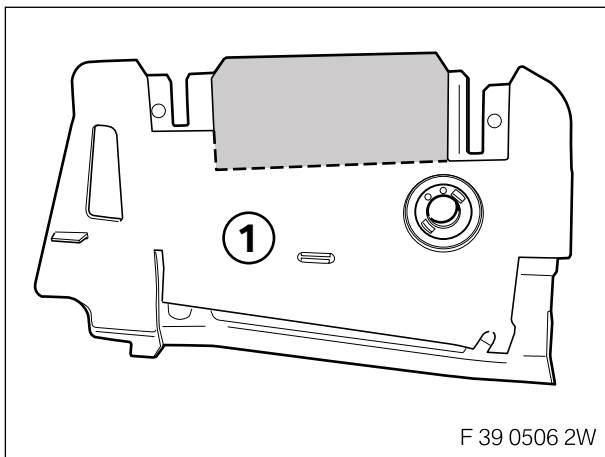

E39 cars only

Position the footwell trim (1) and saw out the section around the Thermo Call control module.

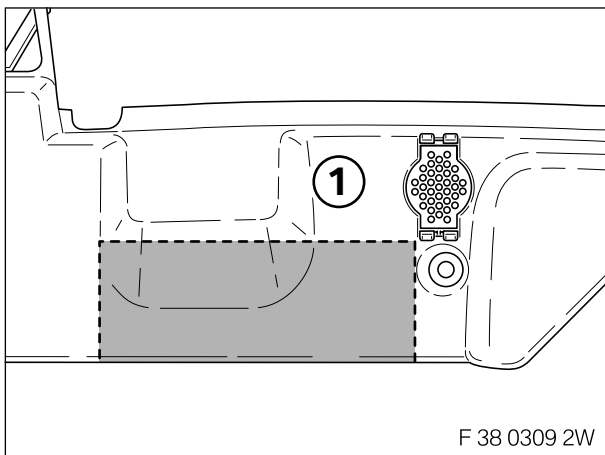

E38 only

Position the footwell trim (1) and saw out the section around the Thermo Call control module.

7. To connect Thermo Call



The connection is shown on an E39 Saloon. Proceed accordingly on the E39 touring (remote control receiver in front of the spare wheel trough) and E38 cars (remote control receiver on the left behind the rear seat bench). ◀

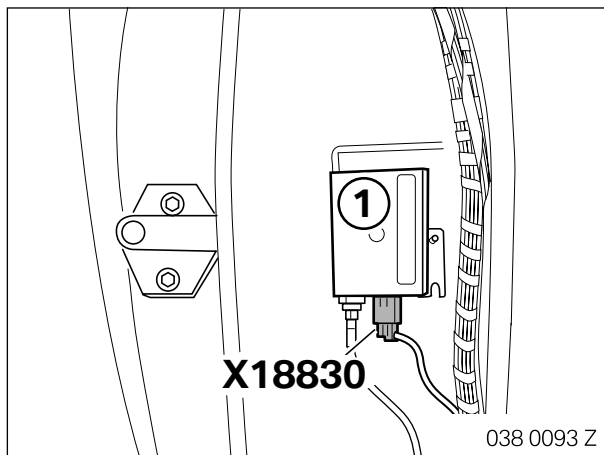

Cars with T60 remote control only



The T60 remote control receiver can be identified by its 6-pin white plug casing. ◀

Disconnect the plug **X18830** from the receiver (1).

Disconnect all the cables from the white plug **X18830**.

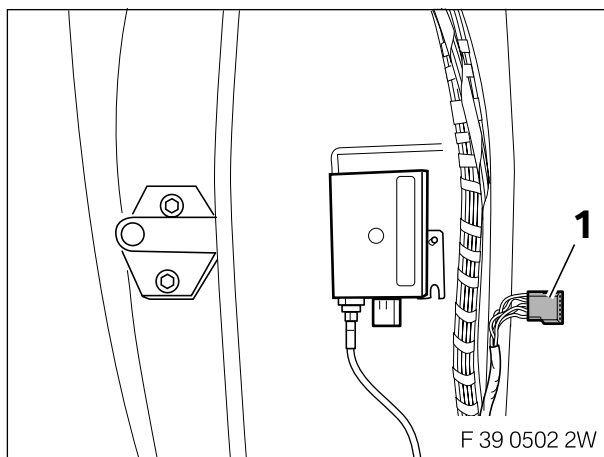

Connect the disconnected cables into the supplied black plug (1) as follows:



The WS/BL cable has not been used since 3/99. ◀

RT/SW cable in PIN 1

WS/GR cable in PIN 3

WS/BL cable in PIN 4

BR cable in PIN 6

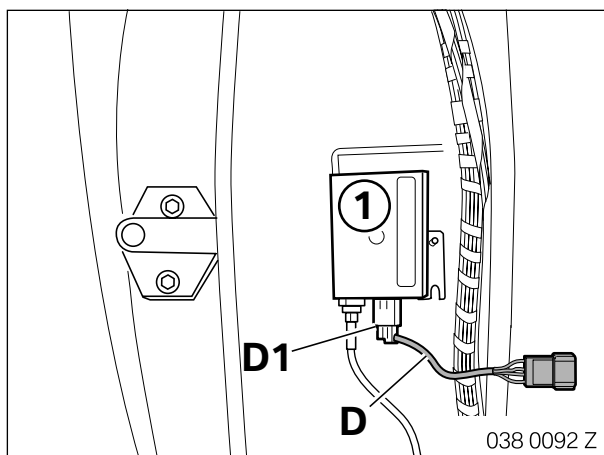

Connect connector **D1** on the adapter cable **D** to the receiver.

7. To connect Thermo Call

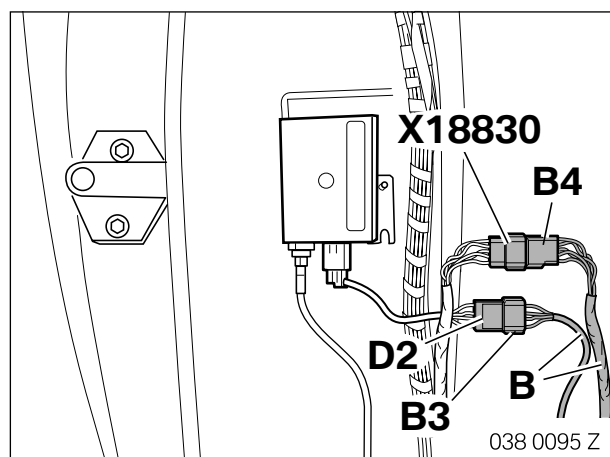

Connector **B3** on the extension **B** is marked with a banderole B3. Connector **B4** on the extension **B** is marked with a banderole B4. ◀

Connect branch **B4** on the extension **B** to the reconnected plug **X18830**.

Connect connector **D2** on the adapter cable **D** to connector **B3** on the extension **B**.

Lay the extension **B** on the right-hand side of the car to the glove compartment.

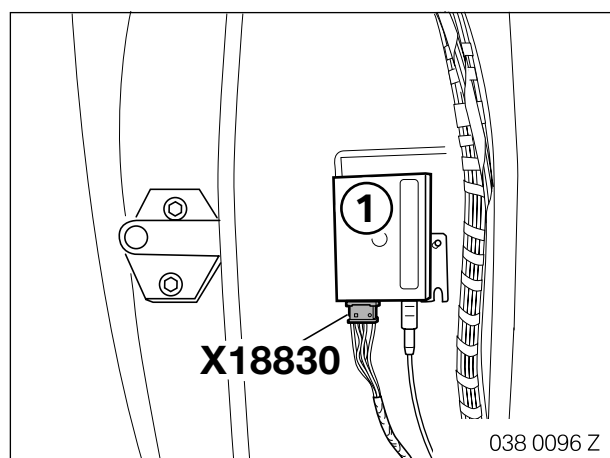

The T70/T80 remote control receiver can be identified by its 6-pin black plug casing. ◀

Disconnect the plug **X18830** from the receiver (1).

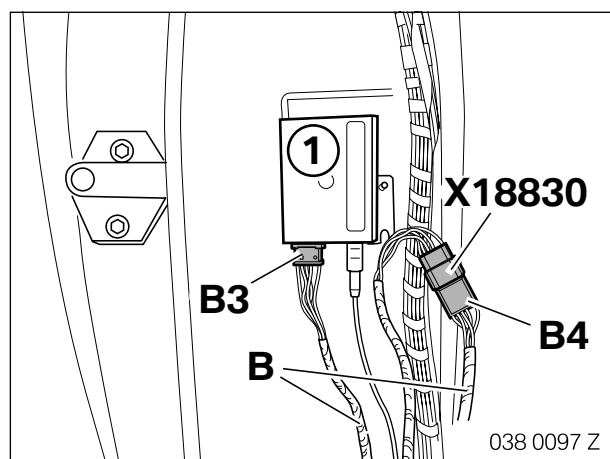

Connector **B3** on the extension **B** is marked with a banderole B3. Connector **B4** on the extension **B** is marked with a banderole B4. ◀

Connect branch **B4** on the extension **B** to plug **X18830**.

Connect connector **B3** on the extension **B** to the receiver (1).

Lay the extension **B** on the right-hand side of the car to the glove compartment.

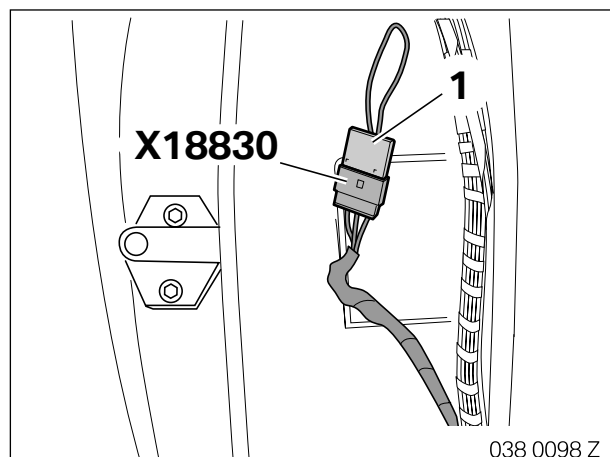

Cars without a remote control only

Disconnect the bridge from the plug **X18830**.

7. To connect Thermo Call

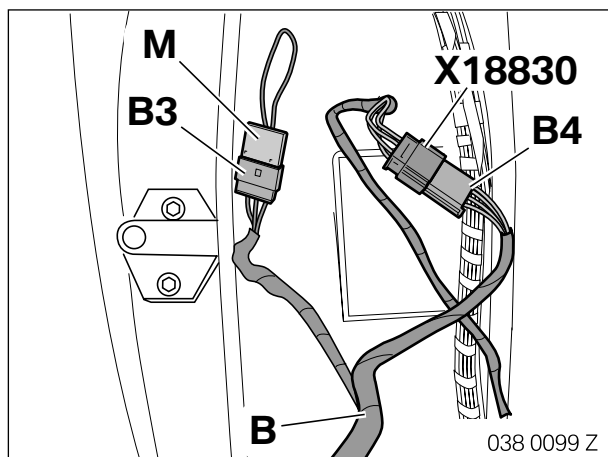

Connector **B3** on the extension **B** is marked with a banderole B3. Connector **B4** on the extension **B** is marked with a banderole B4. ◀

Connect branch **B4** on the extension **B** to plug **X18830**.

Connect a cable bridge **M** on connector **B3** of the extension **B**.

Lay the extension **B** on the right-hand side of the car to the glove compartment.

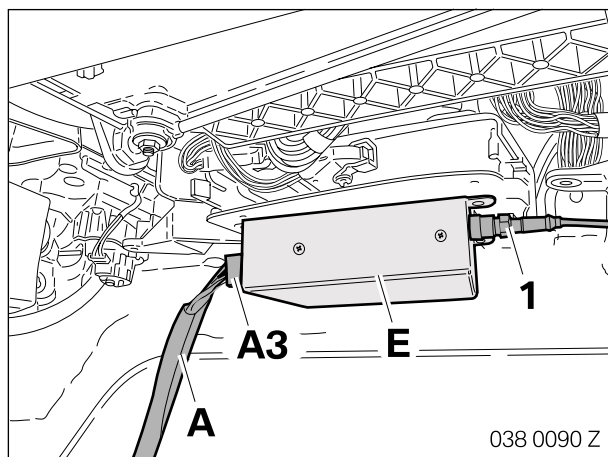

All cars

Connect the aerial cable (1) and branch **A3** to the Thermo Call control module **E**.



Connector **B1** on the extension **B** is marked with a banderole B1. Connector **B2** on the extension **B** is marked with a banderole B2. ◀

Connect the wiring harness **A** to the extension **B**.

8. To install the LED



The LED supplied in the retrofit kit may only be fitted if the auxiliary heating system is not controlled using MID, BC, BM or using multifunctional clock or remote control. ◀

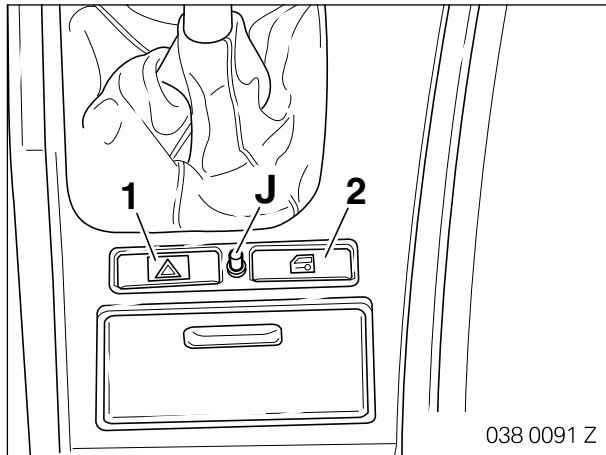

Mark the hole for the LED **J** on the centre console between the hazard lights switch (1) and central locking button (2).

Drill the hole with a diameter of 8.1 mm.

Insert the LED **J** and check that it moves easily. If necessary enlarge the hole a little with a round file.

Lay the LED connection cable **J** towards the glove compartment.

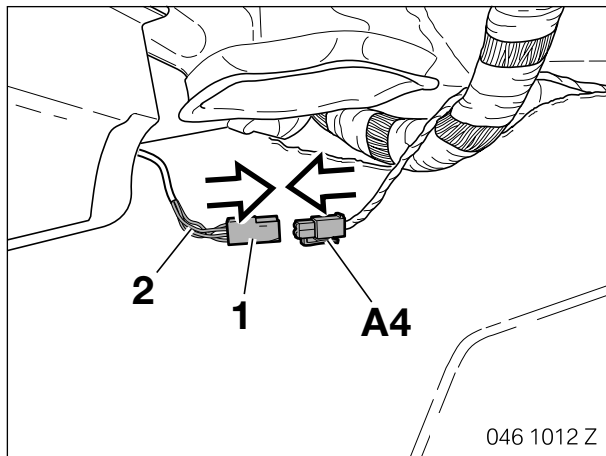

Connect the plug (1) to branch **A4** and connect the connection cable (2) to the same cables in the plug (1).

9. Concluding work and programming

- This Thermo Call retrofit kit does not require coding.
- Assemble the car again following the instructions to dismantle it in reverse order.

To program Thermo Call



The Thermo Call may only be programmed if you have not fitted the LED. If you program it when the LED has been fitted, it will suffer from malfunctions. ◀

- Call Thermo Call.
- When you are asked to enter the password, enter the following technician password:
- *1901*
- and then enter the following number:
- *1*
- This concludes the programming.

The precise instructions for operating the Thermo Call are set out in section 11 or the separate owner's handbook.

10. Thermo Call circuit diagram

046 0958 Z

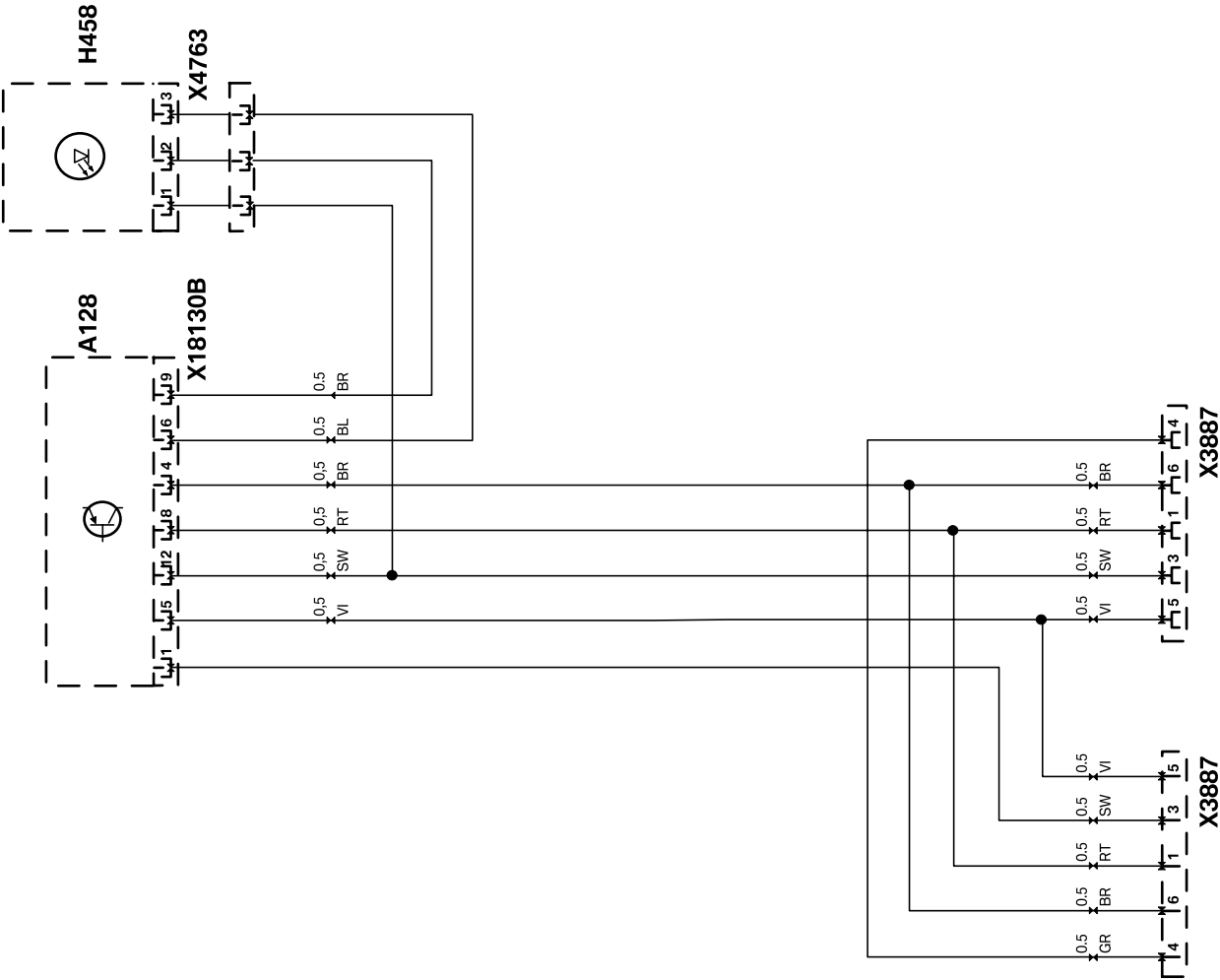

10. Thermo Call circuit diagram

Legend

A128	Thermo Call control module
H458	LED
X3887	6-pin black plug
X4763	4-pin white plug
X18130B	12-pin black socket contact plug

Cable colours

BL	blue
BR	brown
GE	yellow
GN	green
GR	grey
OR	orange
RT	red
SW	black
VI	violet
WS	white

11. How to use and test Thermo Call



The SIM card must be inserted before you install the Thermo Call control module.

Do not insert or remove the SIM card when the Thermo Call control module is connected to the voltage supply. This will cause damage to the module or to the SIM card. ◀



Due to its design, the auxiliary ventilation function cannot be controlled on E38/E39 cars with an series auxiliary heating system using Thermo Call. ◀

The complete description of the Thermo Call is set out in the owner's handbook supplied with the retrofit kit. You should set the time in Thermo Call before you hand the car back to the customer.

General instructions for Thermo Call

Thermo Call makes it possible to operate the auxiliary heating system by phone. The telephone must support the transmission of multi-frequency dial tones.

When it is supplied the password is set to **00** and should only be changed by the customer.

To test Thermo Call

- Call Thermo Call.
- When you are asked for the Thermo Call password, enter it and confirm it by pressing **#**.
- Switch on the auxiliary heating system by pressing **1**.
- The Thermo Call confirms your entry.
- Break the connection.
- Check the function of the auxiliary heating system.
- Allow the auxiliary heating system to run for a few minutes.
- Call Thermo Call.
- When you are asked for the Thermo Call password, enter it and confirm it by pressing **#**.
- Switch off the auxiliary heating system by pressing **1**.
- The Thermo Call confirms your entry.
- Break the connection.
- The auxiliary heating system will stop heating the car but will continue to operate for approx. three minutes.