

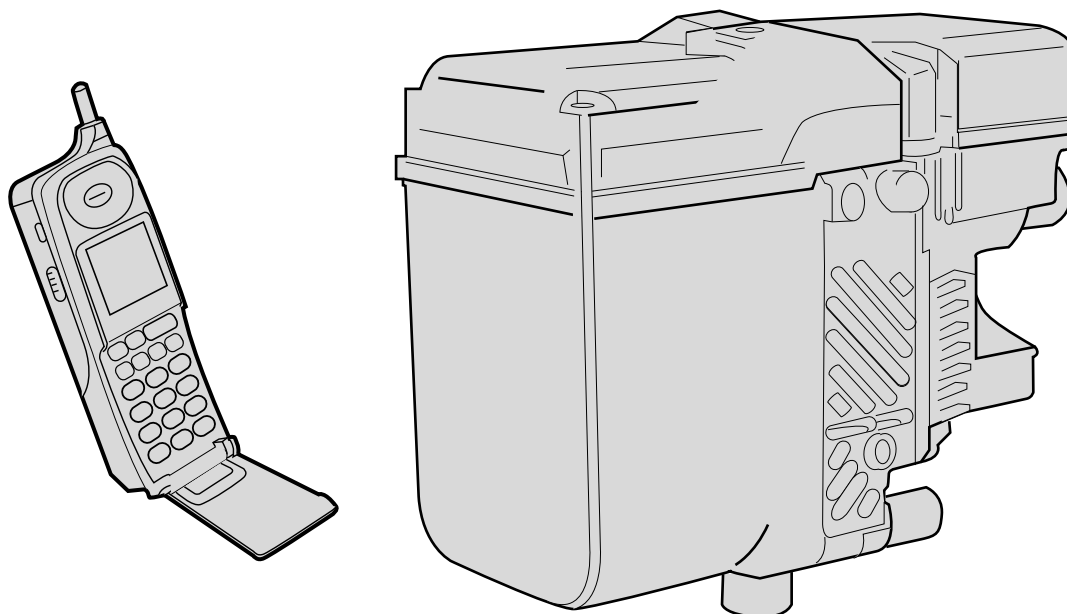

Parts and Accessories Installation Instructions



053 0307 Z

Thermo Call 1.1 retrofit kit **BMW 5 Series (E 39) and 7 Series (E 38) with INLINE auxiliary heating system**

The installation time including the installation of the LED is approx. 1 - 1,5 hours, but this may vary depending on the condition of the car and the equipment in it (the installation time will be reduced to 1 hour if the Thermo Call is installed at the same time as the retrofit auxiliary heating system).

Retrofit kit No. 64 50 0 149 365
 64 50 0 151 210
 64 50 0 151 211



In the Federal Republic of Germany the Vodafone contract and the registration form must be completed immediately after the car is accepted and then sent to the specified fax number.

In other countries a prepaid card must be purchased on which the PIN query can be disabled.

The phone number for Thermo Call is available from the relevant network operator. ◀

Contents

Section	Page
Important information.....	3
1. Preparations.....	4
2. Parts list	5
3. Thermo Call wiring harness connection diagram	6
4. Thermo Call additional cable connection diagram	7
5. To install the Thermo Call aerial	8
6. To install the Thermo Call control module	9
7. To connect Thermo Call	10
8. To install the LED	15
9. Concluding work and programming	16
10. Thermo Call circuit diagram	17
11. How to use and test Thermo Call	19

Important information

The retrofit kit is for use within the BMW dealership organisation only.

Do not kink or damage the cables during the installation work since otherwise they may cause faults that can later only be identified by extensive additional work. The costs incurred as a result of this will not be reimbursed by BMW.

If the specified PIN chambers are occupied, bridges, double crimps or twin-lead terminals must be used.

This Thermo Call retrofit kit does not require coding.

The electrical connection of Thermo Call is made in parallel to the connection **X18830** of the receiver for the auxiliary heating system. Depending on the model, this may be either on the right-hand side of the car behind the glove compartment or on the left near the light switch.

The LED supplied in the retrofit kit may only be fitted if the auxiliary heating system is not controlled using MID, BC, BM or using multifunctional clock or remote control.

Target group

The target group for these installation instructions is specialist personnel trained on BMW cars with specialist knowledge of vehicle electrical systems.

Work:

All servicing, repair and installation work on BMW cars is completed at your own risk.

All work must be completed using the latest BMW repair manuals and circuit diagrams in a rational order using the prescribed tools (special tools) and observing current health and safety regulations.



The SIM card must be inserted before you install the Thermo Call control module.

Do not insert or remove the SIM card when the Thermo Call control module is connected to the voltage supply. This will cause damage to the module or to the SIM card. ◀

Thermo Call licence

European Union and conformity states

Directive 95/54/CE

Regulation No. 10 ECE-ONU/2

e3*72/245*95/54*7001*00

E3 10R-02 7001-00

Special tools required

DISPlus, MoDiC III or GT-1

1. Preparations

	TIS instruction No.
Conduct a brief test	---
Disconnect the negative pole of the battery	12 00 ...

The following components must be removed first of all:	---
Glove compartment	51 16 360
Base module	51 10 210
A pillar trim on the right	51 43 201
Footwell trim on the left (only if the receiver is fitted behind the light switch)	51 45 185
Also remove the following components if you wish to install the LED:	
Gearshift/Selector lever cover	51 10 210
Hazard lights and central locking button	61 31 079

2. Parts list

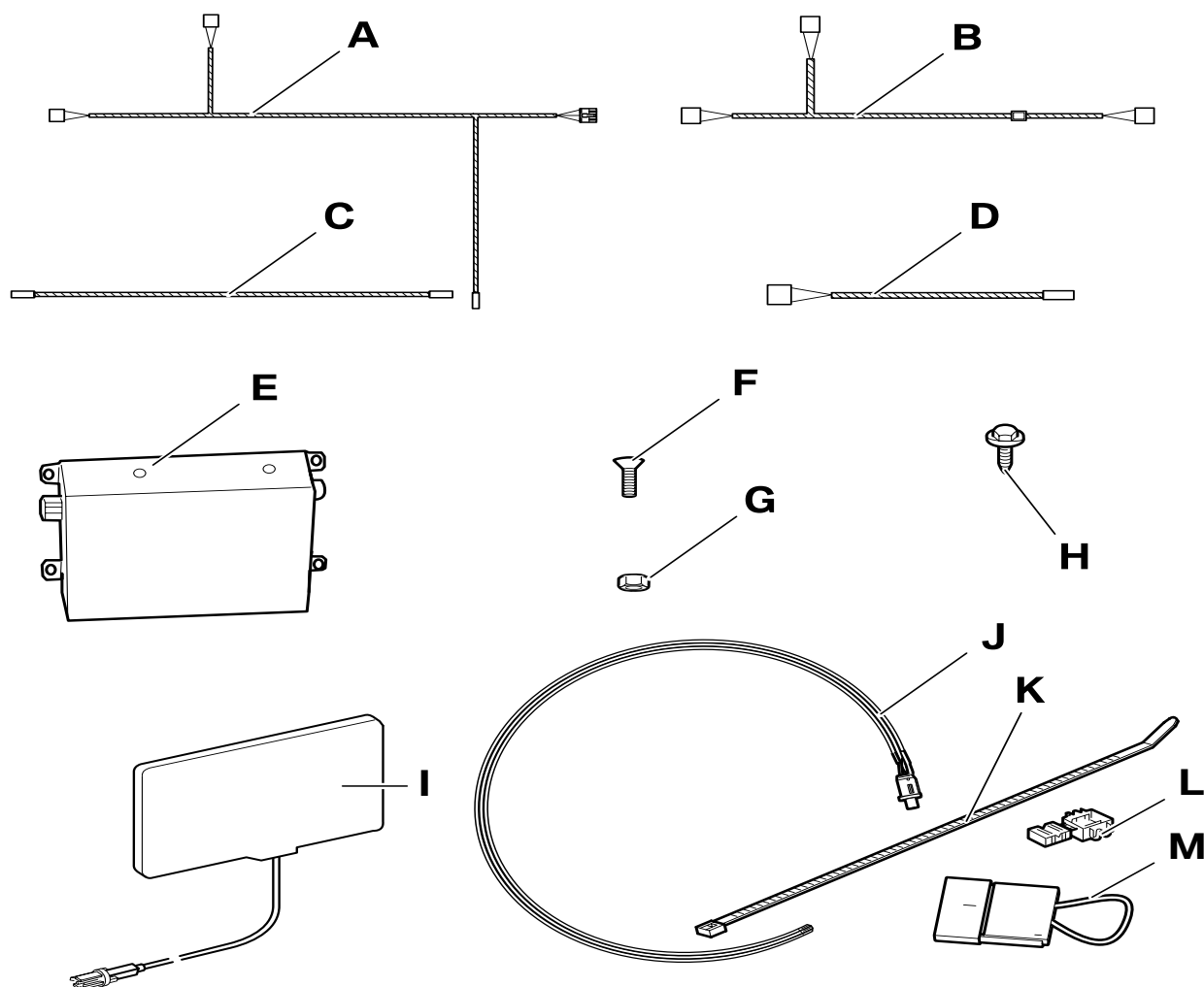

053 0337 Z

Legend

- A Thermo Call wiring harness
- B Thermo Call wiring harness extension (not required)
- C LED extension (not required)
- D Adapter cable (not required)
- E Thermo Call control module
- F Countersunk screw M4 x 25 mm (4x)
- G Hexagonal nut M4 (4x)
- H Fillister head self-tapping screws St 2.9 x 25 (4x)
- I Adhesive aerial
- J LED
- K Cable tie (20x)
- L Connector (4x)
- M Cable bridge

3. Thermo Call wiring harness connection diagram

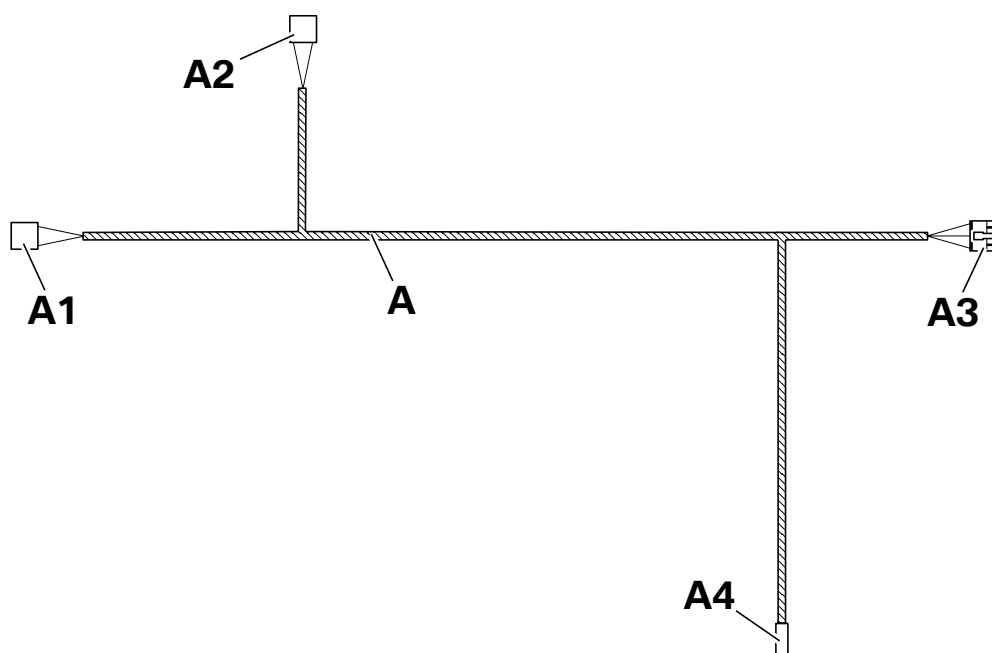

053 0344 Z

Item	Description	Signal	Cable colour / Cross-section	Connection location in the car	Abbreviation / Slot
A	Thermo Call wiring harness	---	---	---	---
A1	6-pin black plug	---	---	On the remote control receiver for the auxiliary heating system*	X3887B
A2	6-pin black plug	---	---	To the 6-pin black plug X18830 on the auxiliary heating system wiring harness	X3887S
A3	12-pin black plug	---	---	To Thermo Call control module	X18130
A4	4-pin plug, white	---	---	To the LED J	X4763

*If no remote control is fitted, connect the bridge **M** to the branch **A1**.

4. Thermo Call additional cable connection diagram

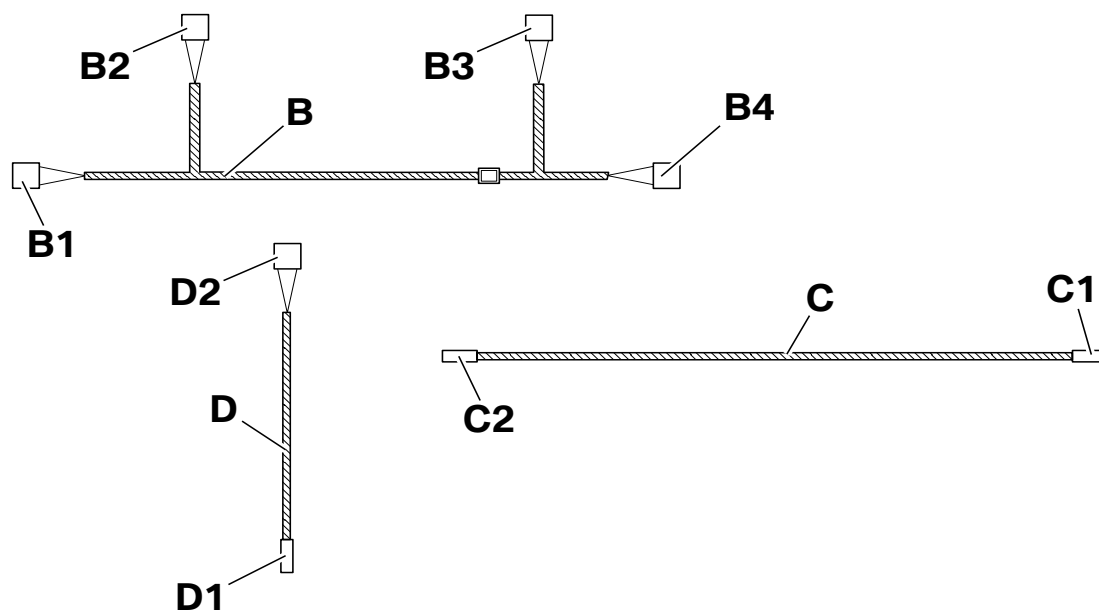

053 0345 Z



The additional cables **B**, **C** and **D** are not required for E38/E39 cars with INLINE auxiliary heating systems. ◀

5. To install the Thermo Call aerial

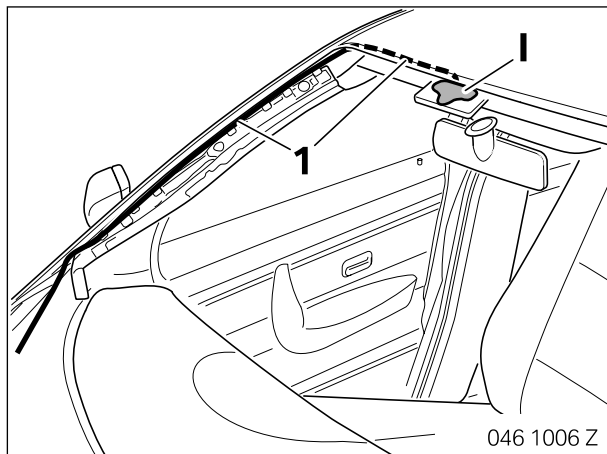

Install the aerial cable (1) in such a way that the deployment of the head airbag is not impeded. ◀

Clean the windscreen in the area where the aerial is to be affixed.

The gluing temperature must be at least 20°C.

Affix the aerial I on the right next to the rear-view mirror.

Lay the aerial cable (1) along the standard wiring harness to the installation site of the Thermo Call control module.

6. To install the Thermo Call control module

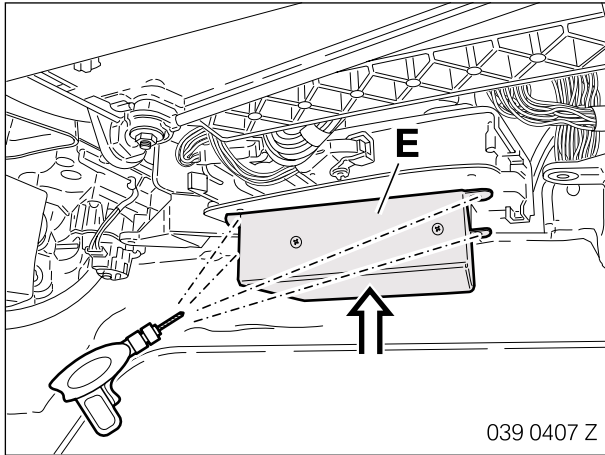

Place the Thermo Call control module **E** against the module holder and mark the holes.

Drill the holes with a 6 mm drill bit.

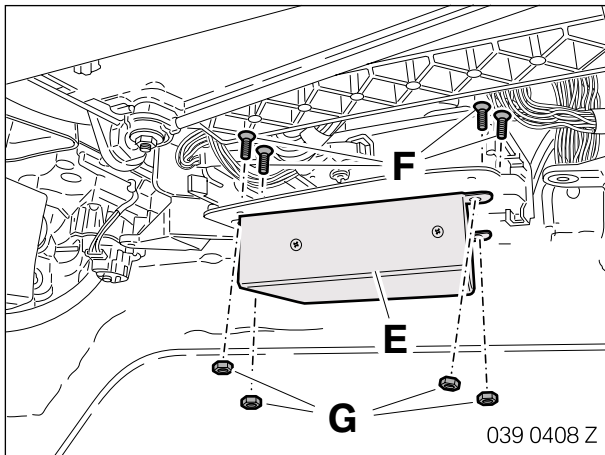

Secure the Thermo Call control module **E** with countersunk screws **F** and hexagonal nuts **G**.

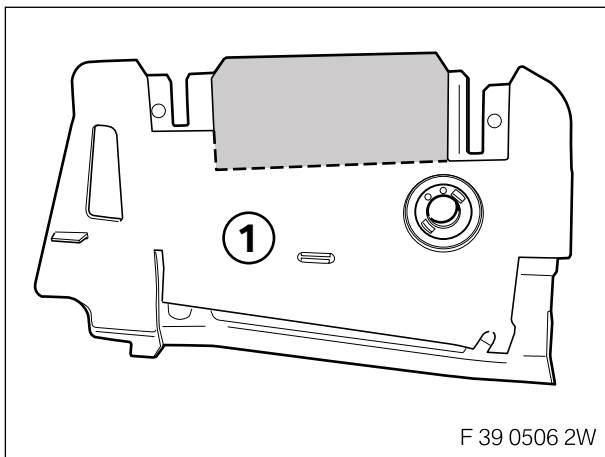

E39 cars only

Position the footwell trim (1) and saw out the section around the Thermo Call control module.

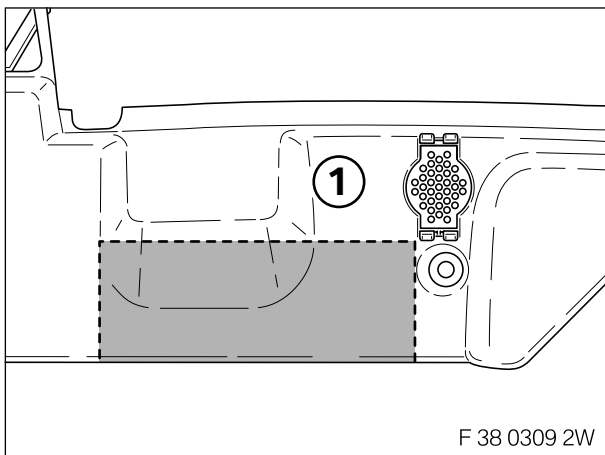

E38 only

Position the footwell trim (1) and saw out the section around the Thermo Call control module.

7. To connect Thermo Call

E38 cars only

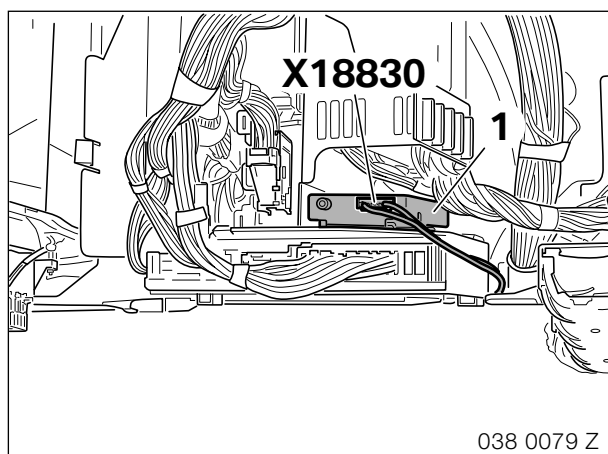

Disconnect the plug **X18830** from the receiver (1).

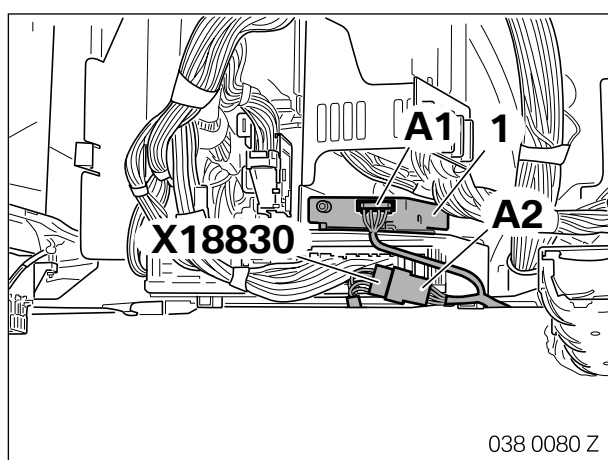

Connect branch **A2** to the plug **X18830**.

Connect branch **A1** to the receiver (1).

7. To connect Thermo Call

E39 cars only with plug X18830 on the right-hand side of the car

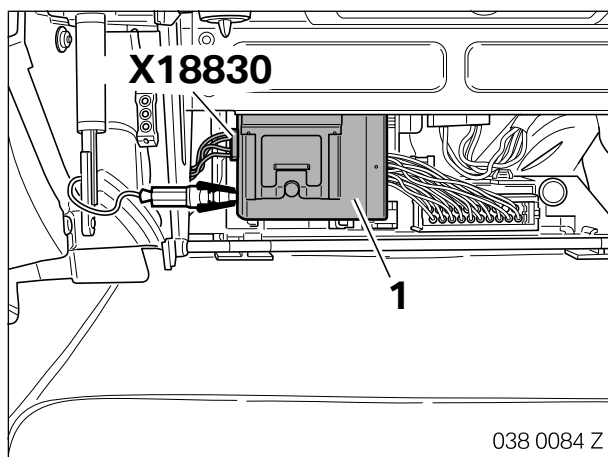

Disconnect the plug **X18830** from the receiver (1).

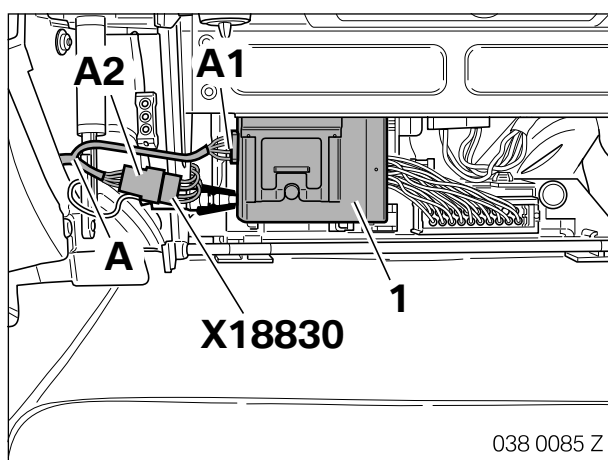

Connect branch **A2** to the plug **X18830**.

Connect branch **A1** to the receiver (1).

Lay the wiring harness **A** to the installation site of the Thermo Call control module.

7. To connect Thermo Call

Only cars with plug X18830 on the left-hand side of the car and without remote control T70/T80.

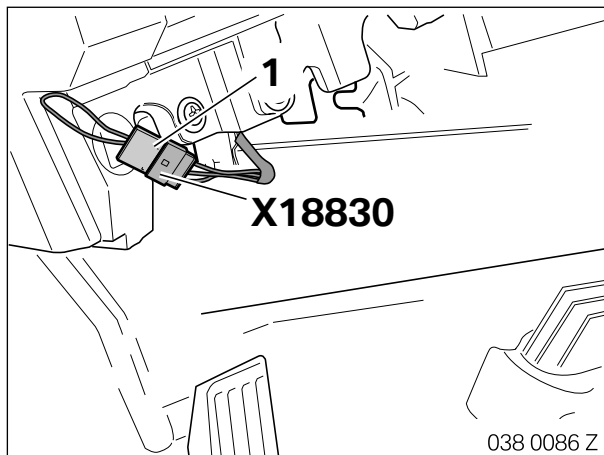

Disconnect the plug **X18830** from the receiver (1).

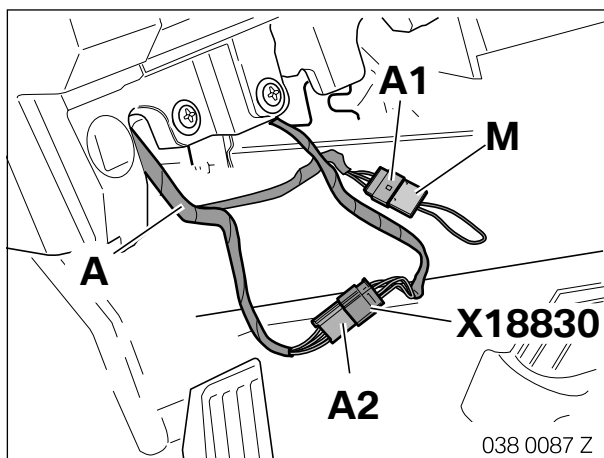

Connect branch **A2** to the plug **X18830**.

Place a bridge **M** on branch **A1**.

Lay the wiring harness **A** to the installation site of the Thermo Call control module.

7. To connect Thermo Call

Only cars with plug X18830 on the left-hand side of the car and with remote control T70/T80.

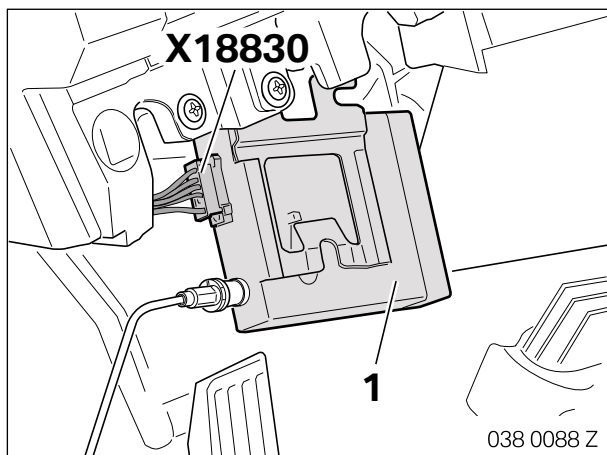

Disconnect the plug **X18830** from the receiver (1).

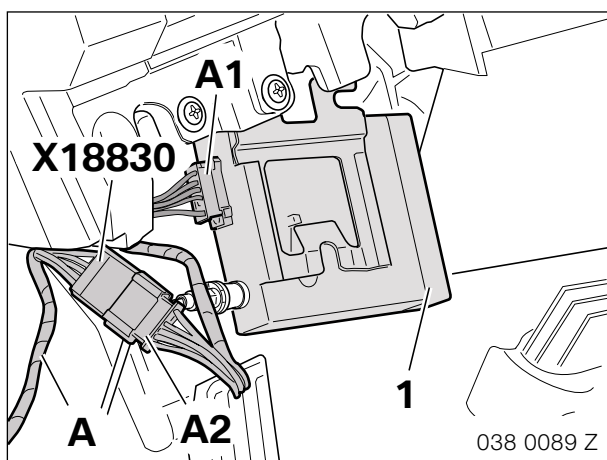

Connect branch **A2** to the plug **X18830**.

Connect branch **A1** to the receiver (1).

Lay the wiring harness **A** to the installation site of the Thermo Call control module.

7. To connect Thermo Call

All cars

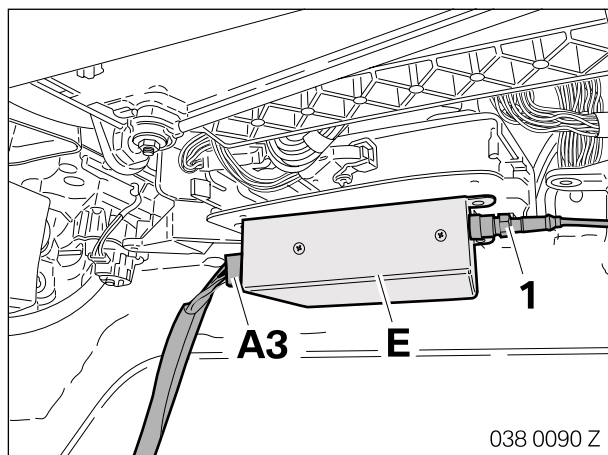

Connect the aerial cable (1) and branch **A3** to the Thermo Call control module **E**.

8. To install the LED



The LED supplied in the retrofit kit may only be fitted if the auxiliary heating system is not controlled using MID, BC, BM or using multifunction clock or remote control. ◀

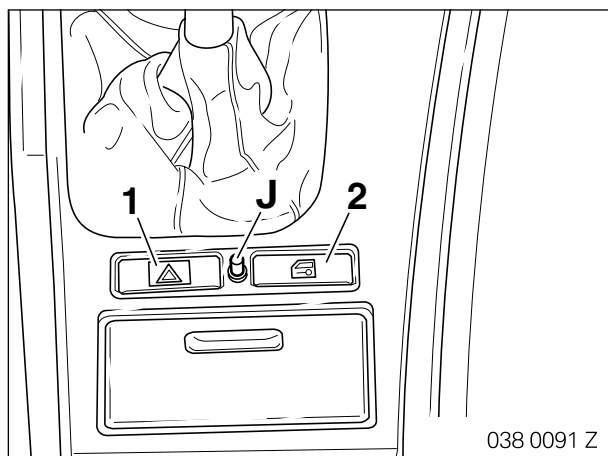

Mark the hole for the LED **J** on the centre console between the hazard lights switch (1) and central locking button (2).

Drill the hole with a diameter of 8.1 mm.

Insert the LED **J** and check that it moves easily. If necessary enlarge the hole a little with a round file.

Lay the LED connection cable **J** towards the glove compartment.

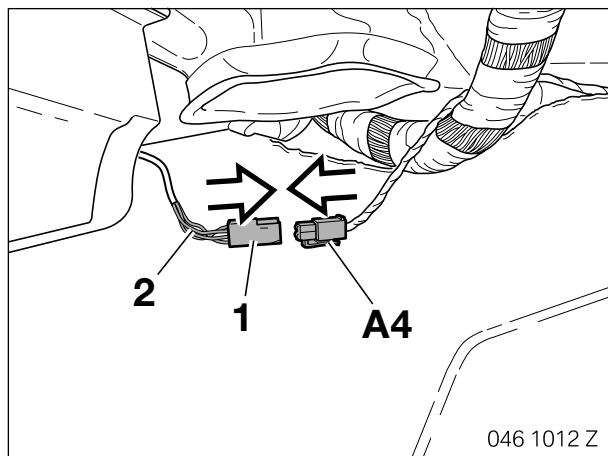

Connect the plug (1) to branch **A1** and connect the connection cable (2) to the same cables in the plug (1).

9. Concluding work and programming

- This Thermo Call retrofit kit does not require coding.
- Assemble the car again following the instructions to dismantle it in reverse order.

To program Thermo Call



The Thermo Call may only be programmed if you have not fitted the LED. If you program it when the LED has been fitted, it will suffer from malfunctions. ◀

- Call Thermo Call.
- When you are asked to enter the password, enter the following technician password:
- *1901*
- and then enter the following number:
- *1*
- This concludes the programming.

The precise instructions for operating the Thermo Call are set out in section 11 or the separate owner's handbook.

10. Thermo Call circuit diagram

046 0958 Z

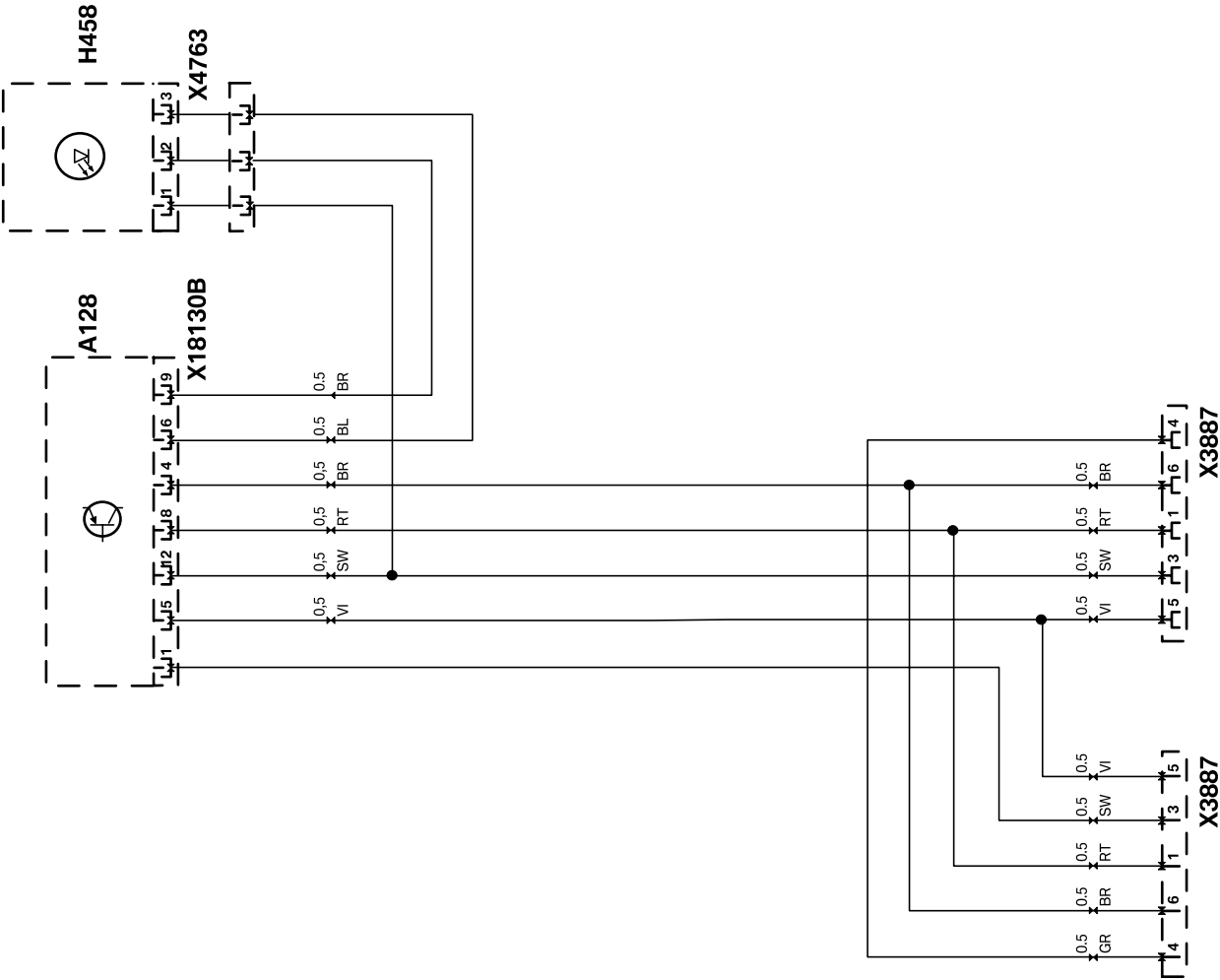

10. Thermo Call circuit diagram

Legend

A128	Thermo Call control module
H458	LED
X3887	6-pin black plug
X4763	4-pin white plug
X18130B	12-pin black socket contact plug

Cable colours

BL	blue
BR	brown
GE	yellow
GN	green
GR	grey
OR	orange
RT	red
SW	black
VI	violet
WS	white

11. How to use and test Thermo Call



The SIM card must be inserted before you install the Thermo Call control module.

Do not insert or remove the SIM card when the Thermo Call control module is connected to the voltage supply. This will cause damage to the module or to the SIM card. ◀



As a result of its design, the auxiliary ventilation function is only possible using Thermo Call on E39 cars with a petrol engine. ◀

The complete description of the Thermo Call is set out in the owner's handbook supplied with the retrofit kit. You should set the time in Thermo Call before you hand the car back to the customer.

General instructions for Thermo Call

Thermo Call makes it possible to operate the auxiliary heating system by phone. The telephone must support the transmission of multi-frequency dial tones.

When it is supplied the password is set to **00** and should only be changed by the customer.

To test Thermo Call

- Call Thermo Call.
- When you are asked for the Thermo Call password, enter it and confirm it by pressing **#**.
- Switch on the auxiliary heating system by pressing **1**.
- The Thermo Call confirms your entry.
- Break the connection.
- Check the function of the auxiliary heating system.
- Allow the auxiliary heating system to run for a few minutes.
- Call Thermo Call.
- When you are asked for the Thermo Call password, enter it and confirm it by pressing **#**.
- Switch off the auxiliary heating system by pressing **1**.
- The Thermo Call confirms your entry.
- Break the connection.
- The auxiliary heating system will stop heating the car but will continue to operate for approx. three minutes.